

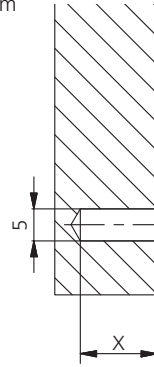

Cabineo

Pat. pend.

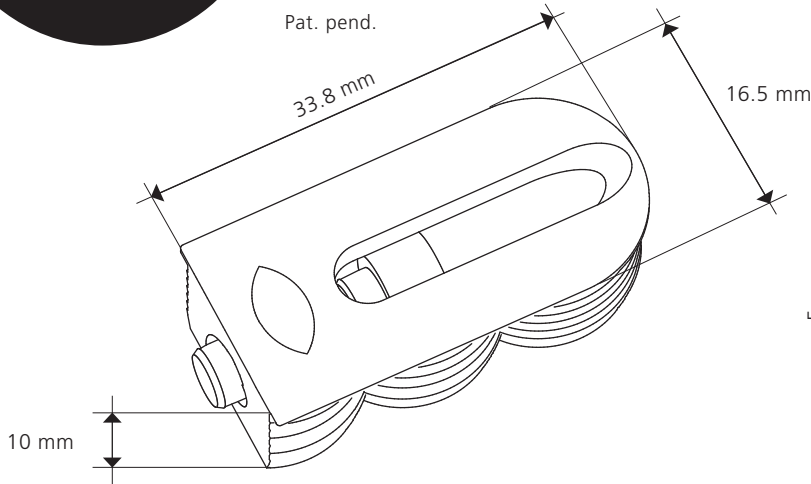

Bearbeitung: Seite

Machining: Side panel

Bohrer / Drill Ø 5 mm
(HPL -> Ø 5.5 mm)

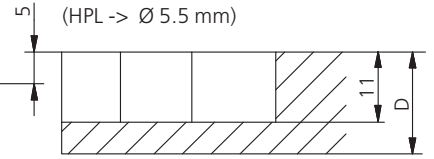

Cabineo 8: X = 8 mm, schwarze Schraube / black screw

Cabineo 12: X = 12 mm, vernickelte Schraube / nickel-plated screw

Bearbeitung: Boden, Zwischenboden oder Deckel / **Machining:** Bottom, top or fixed shelf

Alle Angaben in mm / All details in mm
Download CAD: www.lamello.com

Variante / Option 1:
Bohrer Ø 15 mm
Drill Ø 15 mm

Variante / Option 2:
Fräser Ø 10 mm oder kleiner
Cutter Ø 10 mm or smaller

Variante / Option 3:
Fräser Ø 12 mm
Cutter Ø 12 mm

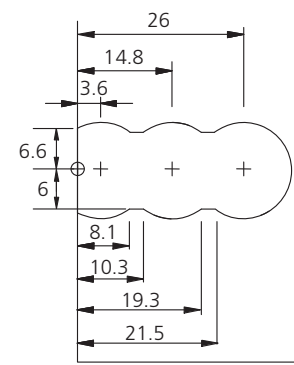
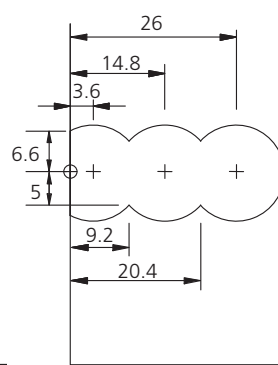
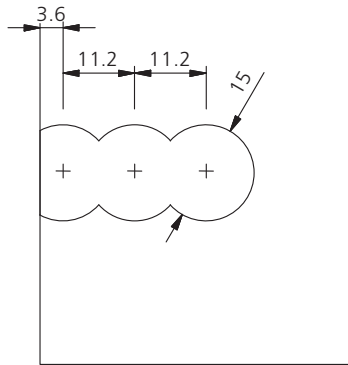
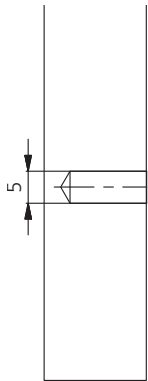

Bearbeitung mit allen CNC-Maschinen / Machining with all CNC machines:

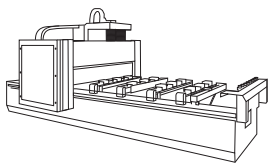

CNC-Bearbeitungszentren mit **Konsolen**
CNC processing centres with **consoles**

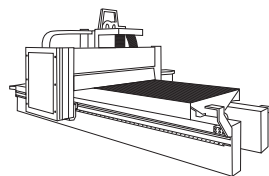

CNC-Bearbeitungszentren mit **Nesting-Technologie**
CNC processing centres with **nesting technology**

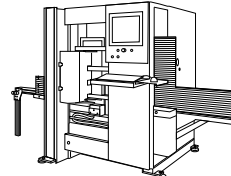

Vertikale
CNC-Bearbeitungszentren
Vertical CNC
processing centres

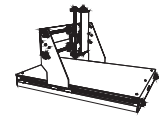

CNC **Oberfräse**
CNC **router**

Montage / Assembly:

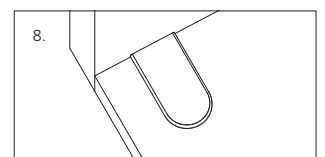
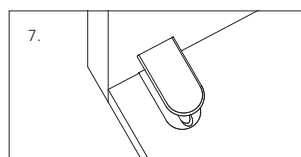
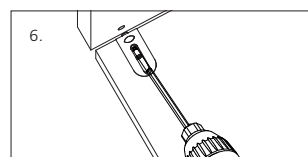
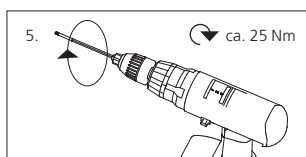
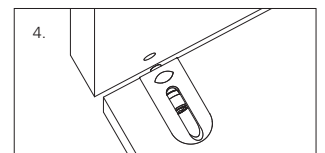
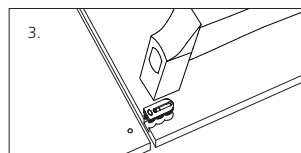
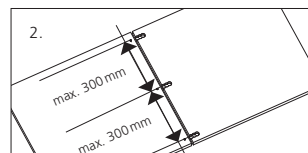
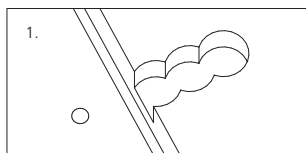

Keine Holzdübel notwendig! / No dowel necessary!

keine Kantenbearbeitung / weniger Bohrungen / weniger Werkzeugwechsel / keine Dübelmontage
No edge drilling / less drill holes / less tool change / no pre-assembly of dowel



Anwendungen / Applications:

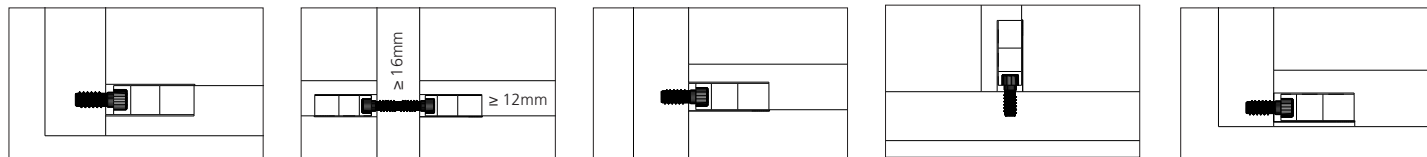

Technische Informationen / Technical information:

| Festigkeit pro Verbinder ohne Dübel / Technical values without dowel (N) in Spanplatte / in particle board 19 mm | Cabineo 12 | Cabineo 8 | Exzenter | Zugfestigkeit / Tensile strength (N) | |
|--|------------|------------|----------|--------------------------------------|-----------|
| | | | | Div. Material | Cabineo 8 |
| Zugfestigkeit / Tensile strength (F1) | 900 | 500 | 500 | HPL | 900 |
| Scherfestigkeit / Shear strength (F2) | 850 | 550 | 550 | Multiplex | 900 |
| Scherfestigkeit / Shear strength (F3) [Var.3] | 400 [-13%] | 400 [-13%] | 450 | CDF | 600 |
| Spannkraft / Clamping force (F4) | 900 | 500 | – | MDF | 400 |

10 N ~ 1kg

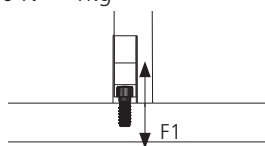

Zugfestigkeit / Tensile strength

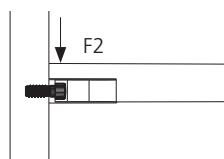

Scherfestigkeit / Shear strength

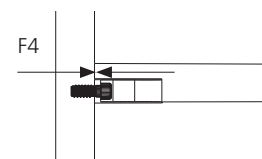
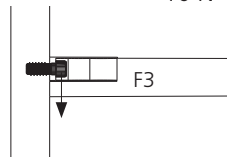

Spannkraft / Clamping force

| Technische Daten | |
|------------------|---------------------------------|
| Grösse | 33.8 × 16.5 × 10.8 mm |
| Fräser | Ø 12 mm oder kleiner |
| Bohrer | Ø 5 mm und Ø 15 mm |
| Material Gehäuse | Glasfaserverstärkter Kunststoff |
| Einbautoleranz | Längs ± 0.1 mm |

| Technical data | |
|-----------------------|--------------------------------|
| Size | 33.8 × 16.5 × 10.8 mm |
| Cutter | Ø 12 mm or smaller |
| Drill | Ø 5 mm and Ø 15 mm |
| Material housing | Fibre-glass reinforced plastic |
| Installation tolerace | Longitudinal ± 0.1 mm |

Artikel / Articles:

| | Art.Nr. |
|---|---------------|
| Cabineo Starterset, Cabineo 8 + 12 (je 40 Stk), inkl. Cabineo Sechskant-Bit und Abdeckkappen (40 Stk)..... | 186305 |
| Cabineo 8, für Mittelwände, 500 Stück | 186310 |
| Cabineo 8, für Mittelwände, 2000 Stück | 186311 |
| Cabineo 12, 500 Stück..... | 186320 |
| Cabineo 12, 2000 Stück..... | 186321 |

| | Art.No. |
|---|---------------|
| Cabineo Starter Set, Cabineo 8 + 12, 40 pcs each, Cabineo hex bit, set of cover caps | 186305 |
| Cabineo 8, for dividing panels, 500 pcs | 186310 |
| Cabineo 8, for dividing panels, 2000 pcs | 186311 |
| Cabineo 12, 500 pcs | 186320 |
| Cabineo 12, 2000 pcs | 186321 |

Zubehör / Accessories:

| Cabineo Werkzeug | Art.Nr. |
|--|---------------|
| Cabineo Werkzeug mit Griff..... | 256300 |
| Cabineo Sechskant-Bit | 276312 |
| Cabineo Bohrer Ø 15 mm mit Zentrierspitze 0.8 mm | 136312 |
| Cabineo Fräser Ø 10 mm..... | 136310 |
| Cabineo Fräser Ø 12 mm..... | 136311 |

| Cabineo Tool | Art.No. |
|---|---------------|
| Cabineo tool with handle | 256300 |
| Cabineo hex bit..... | 276312 |
| Cabineo drill Ø 15 mm with short centering point 0.8 mm.. | 136312 |
| Cabineo cutter Ø 10 mm..... | 136310 |
| Cabineo cutter Ø 12 mm..... | 136311 |

| Cabineo Abdeckkappe | Art.Nr. |
|--|----------------|
| Kunststoff Signalweiss RAL 9003, 100 Stück..... | 186350S |
| Kunststoff Signalweiss RAL 9003, 2000 Stück..... | 186351S |
| Kunststoff Papyrusweiss RAL 9018, 100 Stück | 186350P |
| Kunststoff Papyrusweiss RAL 9018, 2000 Stück | 186351P |
| Kunststoff Fenstergrau RAL 7040, 100 Stück | 186350F |
| Kunststoff Fenstergrau RAL 7040, 2000 Stück | 186351F |
| Kunststoff Braunbeige RAL 1011, 100 Stück..... | 186350B |
| Kunststoff Braunbeige RAL 1011, 2000 Stück..... | 186351B |
| Kunststoff Anthrazit, 100 Stück..... | 186350A |
| Kunststoff Anthrazit, 2000 Stück..... | 186351A |

| Cabineo Cover caps | Art.No. |
|--|----------------|
| Plastic Signal white RAL 9003, 100 pcs | 186350S |
| Plastic Signal white RAL 9003, 2000 pcs | 186351S |
| Plastic Papyrus white RAL 9018, 100 pcs | 186350P |
| Plastic Papyrus white RAL 9018, 2000 pcs | 186351P |
| Plastic Window grey RAL 7040, 100 pcs | 186350F |
| Plastic Window grey RAL 7040, 2000 pcs | 186351F |
| Plastic Brown beige RAL 1011, 100 pcs | 186350B |
| Plastic Brown beige RAL 1011, 2000 pcs | 186351B |
| Plastic Anthracite, 100 pcs | 186350A |
| Plastic Anthracite, 2000 pcs..... | 186351A |